

OCEAN CITY "BRIGANTINE" REEL NO. 111

(Model B)

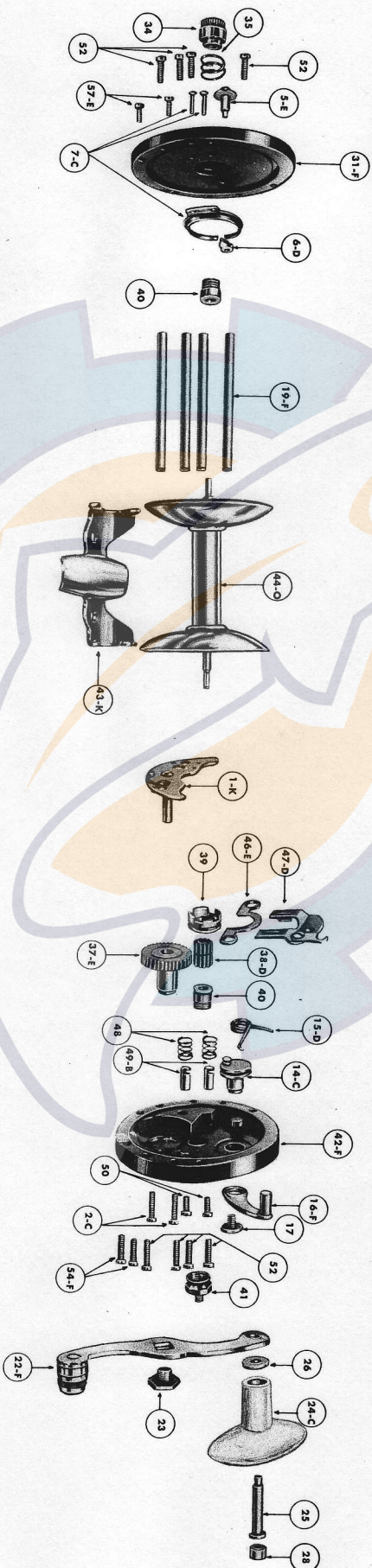

HOW TO ORDER PARTS FOR YOUR REEL—Locate the part desired in the illustration above and note part number. When ordering, state quantity, part number, part name and model letter which you will find on underside of reel stand. Enclose money order, stamps or check. Our minimum charge for one order is \$.25; please add \$.15 on each order for return postage and insurance.

PART No.	PART NAME	PRICE	PART No.	PART NAME	PRICE	PART No.	PART NAME	PRICE	PART No.	PART NAME	PRICE
1-K	Bridge	.35	19-F	Frame Post	.12	34	Left Side Oil Cap	.12	44-O	Spool	1.00
2-C	Bridge Screw	.02	22-F	Handle Complete with Part Nos. 24-C, 25, 26 and 28	.80	35	Left Side Oil Cap Spring	.04	46-E	Yoke	.20
5-E	Click Button	.12	23	Handle Screw	.16	37-E	Main Gear	.50	47-D	Yoke Plate	.30
6-D	Click Pawl	.12	24-C	Handle Knob	.24	38-D	Pinion Gear	.30	48	Yoke Spring	.04
7-C	Click Spring and Rivets	.14	25	Handle Knob Rivet	.06	39	Pinion Gear Clutch	.26	49-B	Yoke Guide Stud	.06
14-C	Eccentric	.50	26	Handle Knob Felt Washer	.01	40	Left and Right Side Bearing	.20	50	Yoke Guide Stud Screw	.02
15-D	Eccentric Spring	.12	28	Handle Knob Oiler	.24	41	Right Side Adjusting Cap	.12	52	Screw, Left & Right Side Plate	.02
16-F	Free Spool Lever	.26	31-F	Left Side Plate Complete with Part Nos. 5-E, 6-D and 7-C	.80	42-F	Right Side Plate	.80	54-F	Screw, Right Side Stand	.02
17	Free Spool Lever Screw	.05				43-K	Stand	.80	57-E	Screw, Left Side Stand	.02